

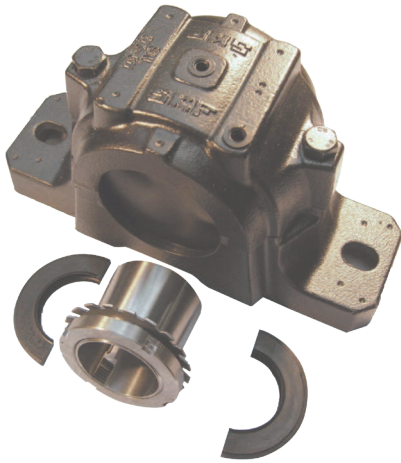

MAUCOUR COOPER BEARING



This type of bearing in diametrical parting is very easy to assemble, its design and implementation have been simplified to allow installation at lower cost.

The body is in grey cast iron and has a good rigidity. These bearings are grease lubricated and can accommodate several types of seals:

- Felt seal, simple and efficient, peripheral speed 4m/s max.
- Double lip seal, resistant to wear and good elasticity, peripheral speed 8m/s.
- Labyrinth seal for difficult conditions, high speeds which support the axial movements.

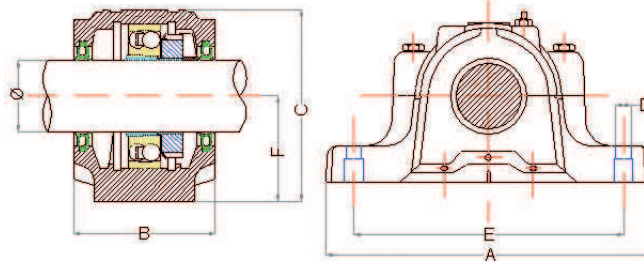

SHAFT Ø	A	B	C	D	E	F	Max. Radial Load (KN)	Reference
25	185	77	89	2 x 12	150	50	65	PALSKFSNL506605
30	185	82	93	2 x 12	150	50	80	PALSKFSNL507606
35	205	85	108	2 x 12	170	60	85	PALSKFSNL508607
40	205	85	109	2 x 12	170	60	90	PALSKFSNL509
45	205	90	113	2 x 12	170	60	110	PALSKFSNL510608
50	255	95	128	2 x 16	210	70	115	PALSKFSNL511609
55	255	105	134	2 x 16	210	70	120	PALSKFSNL512610



Other dimensions on request

Ce document n'est pas contractuel - This document is not contractual